

## FJV-4 Series High Pressure T-Type Filter Assemblies

### Features

- High collapse 4500 psid (310 bard) filter element using SWIFFFELT™ 316 stainless steel medium
- Flows to 45 gpm (170 lpm)
- Port sizes: 3/4" NPT, 1" NPT  
(Other line sizes available, consult factory)

### Notes and Specifications

**Maximum working pressure:**  
8,000 psi (551 bar)

**Proof pressure:**  
9,600 psi (661 bar)

**Burst pressure:**  
Consult factory

**Temperature rating:**  
-100° (-73°C) to 500° (260°C)

### Materials of Construction:

- Head and Body: 304 Stainless Steel standard (316, 17-4PH, Hastelloy® and others available)
- Seal material: Fluorocarbon (Viton®) (Teflon® and Kalrez® and other compounds also available)
- Filter element collapse pressure: 4500 psid (310 bard)
- Element construction: SWIFTMESH™ all 316 stainless steel (no resin binders) medium, 304 stainless steel end caps



### Pressure Drop Information

**Housing Pressure Drop**  
Fluid at 15cSt(77.5 SUS), 0.8572 S.G.

Housing pressure drop is directly proportional to specify gravity.

### FJV-4 Series Housing

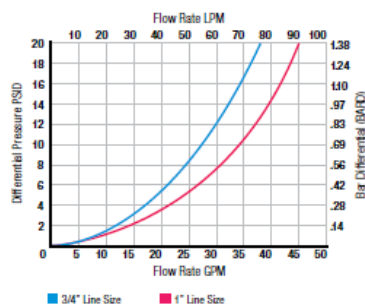

**Element Pressure Drop**  
Fluid at 15cSt(77.5 SUS), 0.8572 S.G.

Correct for other fluids by multiplying new viscosity in cSt/5 (SUS/77.5) x new S.G./0.8572

### FJE-4 Series Element

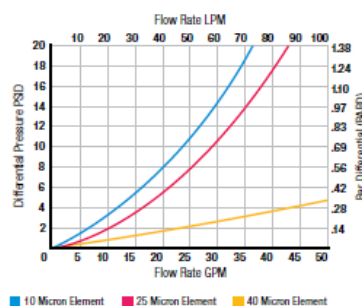

## Dimensional Drawings

Front View

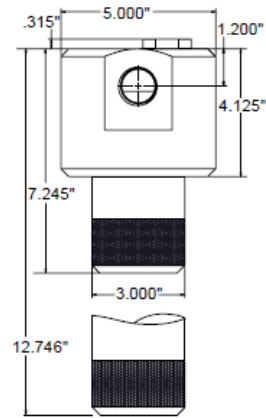

Top View

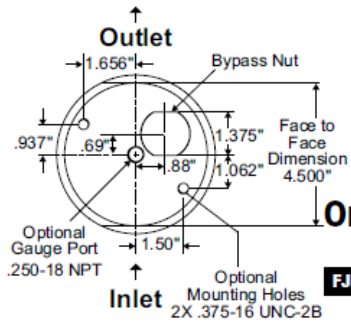

## Ordering Information for Standard High Pressure T-Type Filter Assemblies

FJV	Series	Bypass	Port Size*	Gauge Port	Bowl Size	Seal	Options	Material													
	4			<table border="1"> <tr><td>N=</td><td>NONE</td></tr> <tr><td>VG=</td><td>VISUAL</td></tr> <tr><td>EG=</td><td>ELECTRICAL</td></tr> </table>	N=	NONE	VG=	VISUAL	EG=	ELECTRICAL	<table border="1"> <tr><td>V=</td><td>VITON®</td></tr> <tr><td>T=</td><td>TEFLON®</td></tr> <tr><td>K=</td><td>KALREZ®</td></tr> </table>	V=	VITON®	T=	TEFLON®	K=	KALREZ®	<table border="1"> <tr><td>OMIT=</td><td>304SS</td></tr> </table>	OMIT=	304SS	
N=	NONE																				
VG=	VISUAL																				
EG=	ELECTRICAL																				
V=	VITON®																				
T=	TEFLON®																				
K=	KALREZ®																				
OMIT=	304SS																				
		<table border="1"> <tr><td>X=</td><td>NONE</td></tr> <tr><td>B=</td><td>500 PSID</td></tr> </table>	X=	NONE	B=	500 PSID			<table border="1"> <tr><td>S=</td><td>STANDARD</td></tr> <tr><td>E=</td><td>EXTENDED</td></tr> </table>	S=	STANDARD	E=	EXTENDED	<table border="1"> <tr><td>OMIT=</td><td>NO OPTIONS</td></tr> <tr><td>MH=</td><td>MOUNTING HOLES</td></tr> </table>	OMIT=	NO OPTIONS	MH=	MOUNTING HOLES			
X=	NONE																				
B=	500 PSID																				
S=	STANDARD																				
E=	EXTENDED																				
OMIT=	NO OPTIONS																				
MH=	MOUNTING HOLES																				
			<table border="1"> <tr><td>A03</td><td>= 3/4" NPT</td></tr> <tr><td>A04</td><td>= 1" NPT</td></tr> <tr><td>B02</td><td>= 3/4" SAE (J1926-1 STR THREAD)</td></tr> <tr><td>B03</td><td>= 1" SAE (J1926-1 STR THREAD)</td></tr> <tr><td>C01</td><td>= 1" CODE 61 (FLANGE CONNECTION)</td></tr> <tr><td>C02</td><td>= 1" CODE 62 (FLANGE CONNECTION)</td></tr> </table>	A03	= 3/4" NPT	A04	= 1" NPT	B02	= 3/4" SAE (J1926-1 STR THREAD)	B03	= 1" SAE (J1926-1 STR THREAD)	C01	= 1" CODE 61 (FLANGE CONNECTION)	C02	= 1" CODE 62 (FLANGE CONNECTION)						
A03	= 3/4" NPT																				
A04	= 1" NPT																				
B02	= 3/4" SAE (J1926-1 STR THREAD)																				
B03	= 1" SAE (J1926-1 STR THREAD)																				
C01	= 1" CODE 61 (FLANGE CONNECTION)																				
C02	= 1" CODE 62 (FLANGE CONNECTION)																				

### Example:

#### FJV-4-X-A03-N-E-V

This would be the part number for a standard Series 4 T-type Filter Assembly with a 304 stainless steel housing with no bypass, a 3/4" NPT port, no gauge port, extended bowl and Viton® seal.

\* Other port sizes and material available, consult factory.  
 Viton, Teflon and Kalrez are registered trademarks of E.I. du Pont de Nemours and Company or its affiliates.  
 Hastelloy is a registered trademark of Haynes International, Inc.

## Ordering Information for High Pressure Filter Elements

FJE	Series	Micron	Length						
	4		<table border="1"> <tr><td>OMIT=</td><td>STANDARD LENGTH</td></tr> <tr><td>E=</td><td>EXTENDED LENGTH</td></tr> </table>	OMIT=	STANDARD LENGTH	E=	EXTENDED LENGTH		
OMIT=	STANDARD LENGTH								
E=	EXTENDED LENGTH								
		<table border="1"> <tr><td>3</td></tr> <tr><td>5</td></tr> <tr><td>10</td></tr> <tr><td>20</td></tr> <tr><td>40</td></tr> <tr><td>60</td></tr> </table>	3	5	10	20	40	60	<p>Note: All extended length bowls/sumps require an extended length filter element.</p>
3									
5									
10									
20									
40									
60									

### Example:

#### FJE-4-10E

This would be the part number for a Metal Felt Filter Element made with 316L stainless steel filament with 10 micron media to fit a Series 4 T-type Housing with an extended length bowl.